

027300

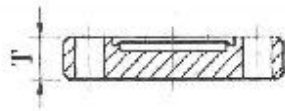

Figure A

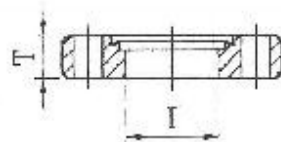

Figure B

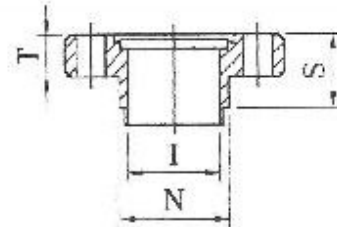

Figure C

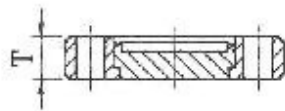

Figure D

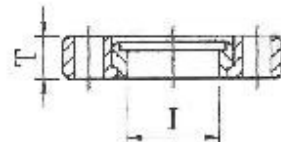

Figure E

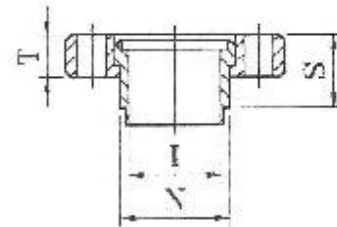

Figure F

CF-16 NONROTATABLE					CF-16 NONROTATABLE-TAPPED				
FIG.	I	N	S	T	FIG.	I	N	S	T
A	-	-	-	7,4	A	-	-	-	7,4
B	6,35	6,35	1,8	7,4	B	6,35	6,35	-	7,4
B	9,65	9,65	1,8	7,4	B	9,65	9,65	-	7,4
B	12,7	12,7	1,8	7,4	B	12,7	12,7	-	7,4
C	16	19,1	1,8	7,4	C	16	19,1	12,7	7,4

CF-16 ROTATABLE					CF-16 ROTATABLE-TAPPED				
FIG.	I	N	S	T	FIG.	I	N	S	T
D	-	-	-	7,4	D	-	-	-	7,4
E	6,35	6,35	-	7,4	B	6,35	6,35	-	7,4
E	9,65	9,65	-	7,4	B	9,65	9,65	-	7,4
E	12,7	12,7	-	7,4	E	12,7	12,7	-	7,4
F	16	19,1	12,7	7,4	F	16	19,1	12,7	7,4

027000

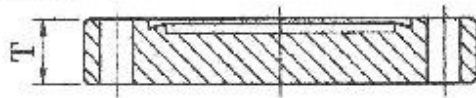

Figure A

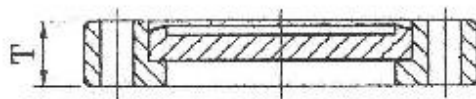

Figure C

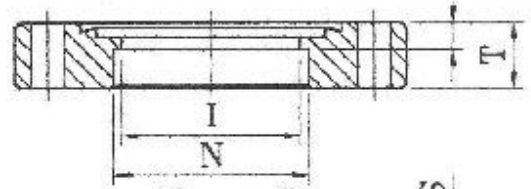

Figure B

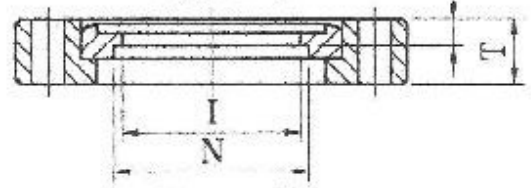

Figure D

CF-40 NONROTATABLE					CF-40 NONROTATABLE-TAPPED				
FIG.	I	N	S	T	FIG.	I	N	S	T
A	-	-	-	12,7	A	-	-	-	12,7
B	3,05	6,35	5,3	12,7	B	3,05	6,35	5,3	12,7
B	9,4	12,7	5,3	12,7	B	9,4	12,7	5,3	12,7
B	15,8	19,1	5,3	12,7	B	15,8	19,1	5,3	12,7
B	22,1	25,4	5,3	12,7	B	22,1	25,4	5,3	12,7
B	28,45	31,8	5,3	12,7	B	28,45	31,8	5,3	12,7
B	34,8	38,1	5,3	12,7	B	34,8	38,1	5,3	12,7

CF-40 ROTATABLE					CF-40 ROTATABLE-TAPPED				
FIG.	I	N	S	T	FIG.	I	N	S	T
A	-	-	-	12,7	A	-	-	-	12,7
B	3,05	6,35	5,3	12,7	B	3,05	6,35	5,3	12,7
B	9,4	12,7	5,3	12,7	B	9,4	12,7	5,3	12,7
B	15,8	19,1	5,3	12,7	B	15,8	19,1	5,3	12,7
B	22,1	25,4	5,3	12,7	B	22,1	25,4	5,3	12,7
B	28,45	31,8	5,3	12,7	B	28,45	31,8	5,3	12,7
B	34,8	38,1	5,3	12,7	B	34,8	38,1	5,3	12,7

027000

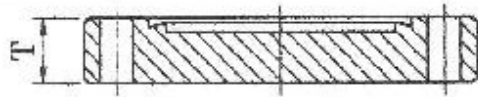

Figure A



Figure C

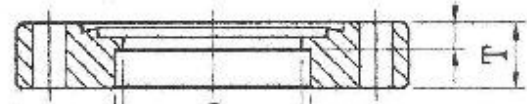

Figure B

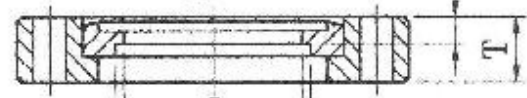

Figure D

CF-63 NONROTATABLE					CF-63 NONROTATABLE-TAPPED				
FIG.	I	N	S	T	FIG.	I	N	S	T
A	-	-	-	17,3	A	-	-	-	17,3
B	34,8	38,1	9,7	17,3	B	34,8	38,1	9,7	17,3
B	47,5	50,8	9,7	17,3	B	47,5	50,8	9,7	17,3
B	60,2	63,5	9,7	17,3	B	60,2	63,5	9,7	17,3

CF-63 ROTATABLE					CF-63 ROTATABLE-TAPPED				
FIG.	I	N	S	T	FIG.	I	N	S	T
A	-	-	-	19,1	A	-	-	-	19,1
B	34,8	38,1	9,7	19,1	B	34,8	38,1	9,7	19,1
B	47,5	50,8	9,7	19,1	B	47,5	50,8	9,7	19,1
B	60,2	63,5	9,7	19,1	B	60,2	63,5	9,7	19,1

027000

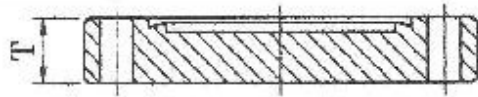

Figure A



Figure C

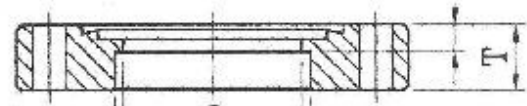

Figure B

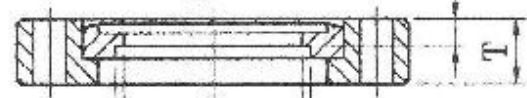

Figure D

CF-100 NONROTATABLE					CF-100 NONROTATABLE-TAPPED				
FIG.	I	N	S	T	FIG.	I	N	S	T
A	-	-	-	19,8	A	-	-	-	19,8
B	97,3	101,6	11,2	19,8	B	97,3	101,6	11,2	19,8

CF-100 ROTATABLE					CF-100 ROTATABLE-TAPPED				
FIG.	I	N	S	T	FIG.	I	N	S	T
A	-	-	-	21,3	A	-	-	-	21,3
B	97,3	101,6	11,2	21,3	B	97,3	101,6	11,2	21,3

027000

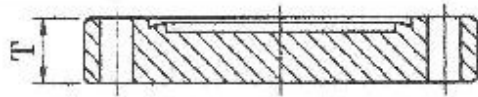

Figure A



Figure C

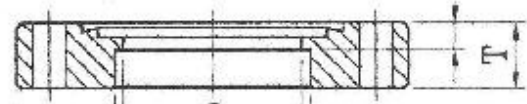

Figure B

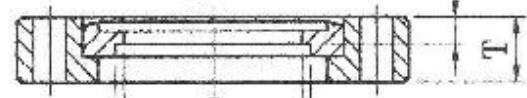

Figure D

CF-160 NONROTATABLE					CF-160 NONROTATABLE-TAPPED				
FIG.	I	N	S	T	FIG.	I	N	S	T
A	-	-	-	22,1	A	-	-	-	22,1
B	148,3	152,4	12,7	22,1	B	148,3	152,4	12,7	22,1

CF-160 ROTATABLE					CF-160 ROTATABLE-TAPPED				
FIG.	I	N	S	T	FIG.	I	N	S	T
A	-	-	-	23,6	A	-	-	-	23,6
B	148,3	152,4	12,7	23,6	B	148,3	152,4	12,7	23,6

027000

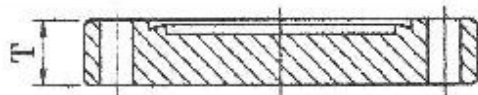

Figure A

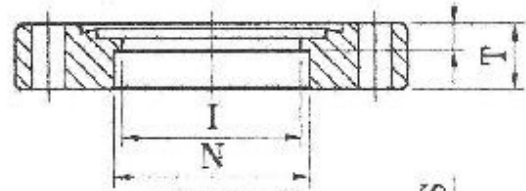

Figure B



Figure C

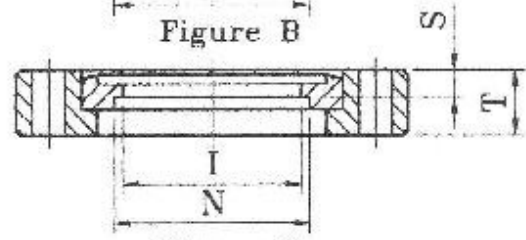

Figure D

CF-200 NONROTATABLE					CF-200 NONROTATABLE-TAPPED				
FIG.	I	N	S	T	FIG.	I	N	S	T
A	-	-	-	24,6	A	-	-	-	24,6
B	197,1	203,2	12,7	24,6	B	197,1	203,2	12,7	24,6

CF-200 ROTATABLE					CF-200 ROTATABLE-TAPPED				
FIG.	I	N	S	T	FIG.	I	N	S	T
A	-	-	-	24,6	A	-	-	-	24,6
B	197,1	203,2	12,7	24,6	B	197,1	203,2	12,7	24,6

027000

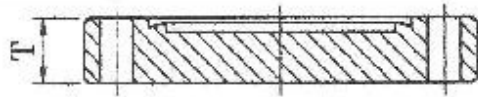

Figure A

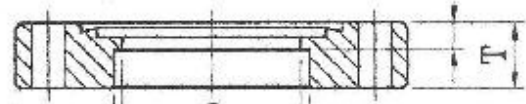

Figure B

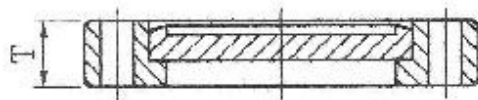

Figure C



Figure D

CF-250 NONROTATABLE					CF-250 NONROTATABLE-TAPPED				
FIG.	I	N	S	T	FIG.	I	N	S	T
A	-	-	-	26,7	A	-	-	-	26,7
B	247,9	254	12,7	26,7	B	247,9	254	12,7	26,7

CF-250 ROTATABLE					CF-250 ROTATABLE-TAPPED				
FIG.	I	N	S	T	FIG.	I	N	S	T
A	-	-	-	26,7	A	-	-	-	26,7
B	247,9	254	12,7	26,7	B	247,9	254	12,7	26,7

027000

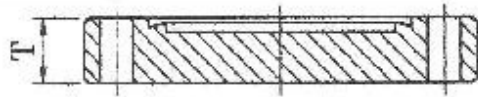

Figure A

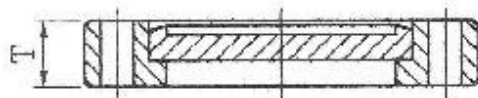

Figure C

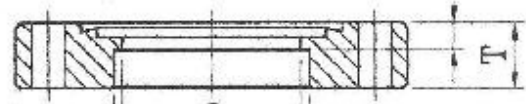

Figure B



Figure D

CF-300 NONROTATABLE					CF-300 NONROTATABLE-TAPPED				
FIG.	I	N	S	T	FIG.	I	N	S	T
A	-	-	-	28,4	A	-	-	-	28,4
B	289,1	295,1	16	28,4	B	289,1	295,1	16	28,4

CF-300 ROTATABLE					CF-300 ROTATABLE-TAPPED				
FIG.	I	N	S	T	FIG.	I	N	S	T
A	-	-	-	23,6	A	-	-	-	23,6
B	289,1	295,1	16	23,6	B	289,1	295,1	16	23,6



HIGH QUALITY SCIENTIFIC RESOURCES

OHFC-COPPER SEALS				
Nr.size		A	B	C
015020 CF 16		21,30	16,20	2
015020 CF 40		48,10	36,80	2
015020 CF 63		82,4	63,60	2
015020 CF 100		120,50	101,70	2
015020 CF 160		171,20	152,50	2
015020 CF200		222,0	203,30	2
015020 CF 250		273,0	254,0	2

513013

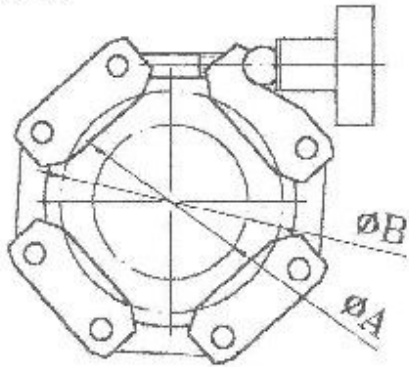

ALUM CHAIN CLAMP				
Nr. Size	A	B min	B max	
513013NW25	25,4	36	45	
513013NW40	38,1	52	60	
513013NW50	50,8	72	79	

513013

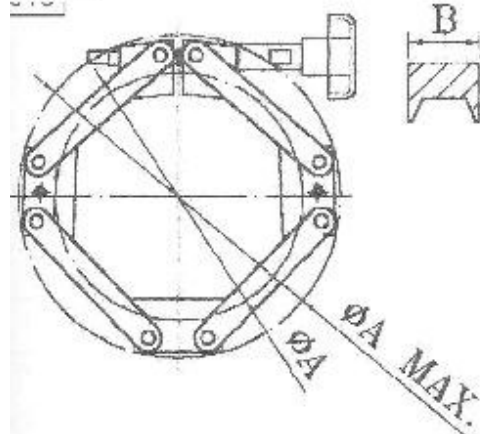

ALUM CHAIN CLAMP				
Nr. Size	A	A min	A min	B
513013NW 80	114	121	158	30
513013NW 100	134	129	176	30