

LARGE FLANGE DOUBLE CLAW CLAMP				
Nr.size	For Tubing	A	B	C
513002ISO63	M8	24.1	50.3	15.7
513002ISO80	M8	24.1	50.3	15.7
513002ISO100	M8	24.1	50.3	15.7
513002ISO160	M10	27.9	52.1	20.3
-	-	-	-	-

515100

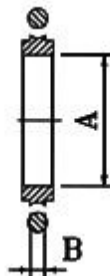

CENTERING RING ASSEMBLY 304 STAINLESS STEEL				
Nr.size	For Tubing	A	B	-
515100ISO63	2.5"	66.8	3.9	-
515100ISO80	3.0"	79.8	3.9	-
515100ISO100	4.0"	98.8	3.9	-
515100ISO160	6.0"	149.9	3.9	-
-	-	-	-	-

515001



REPLACEMENT O-RING (VITON, SILICON, BUNA-N)				
Nr.size	-	A	B	C
515001ISO63	-	72.4	5.3	-
515001ISO80	-	85.1	5.3	-
515001ISO100	-	104.1	5.3	-
515001ISO160	-	151.9	5.3	-
-	-	-	-	-

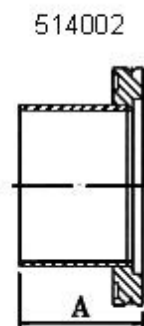
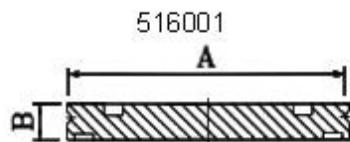
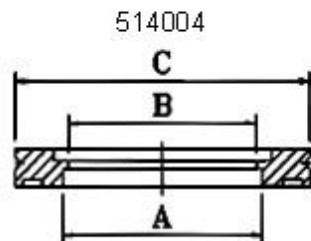

WELD FLANGE 304 STAINLESS STEEL				
Nr.size	For Tubing	A	B	C
514004ISO 63	2.5"	63.5	60.2	95.0
514004ISO 80	3.0"	76.2	72.9	110.0
514004ISO100	4.0"	101.6	98.3	130.0
514004ISO160	6.0"	152.4	148.1	180.1
-	-	-	-	-

BLANK FLANGE 304 STAINLESS STEEL				
Nr.size	For Tubing	A	B	C
516001ISO63	2.5"	95.0	11.9	-
516001ISO80	3.0"	110.0	11.9	-
516001ISO100	4.0"	130.0	11.0	-
516001ISO160	6.0"	180.1	11.9	-
-	-	-	-	-

WELD STUB 304 STAINLESS STEEL				
Nr.size	For Tubing	A	B	C
514002ISO63	2.5"	100	-	-
514002ISO80	3.0"	100	-	-
514002ISO100	4.0"	100	-	-
514002ISO160	6.0"	100	-	-
-	-	-	-	-

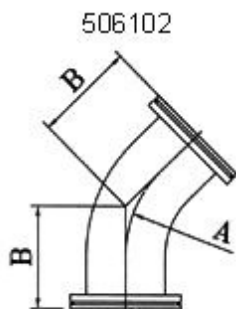
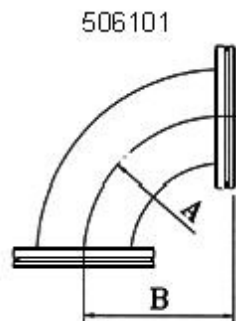
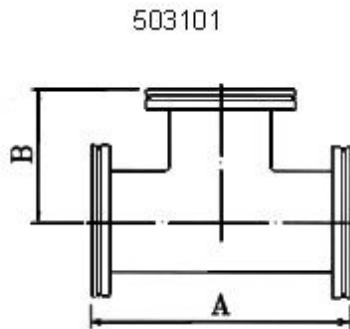

TEE FLANGE 304 STAINLESS STEEL				
Nr.size	For Tubing	A	B	C
503101ISO63	2.5"	165.0	82.5	-
503101ISO80	3.0"	177.8	88.9	-
503101ISO100	4.0"	209.4	104.7	-
-	-	-	-	-
-	-	-	-	-

90° ELBOW FLANGE 304 STAINLESS STEEL				
Nr.size	For Tubing	A	B	C
506101ISO63	2.5"	95.3	101.6	-
506101ISO80	3.0"	114.3	120.6	-
506101ISO100	4.0"	152.4	158.7	-
-	-	-	-	-
-	-	-	-	-

45° ELBOW FLANGE 304 STAINLESS STEEL				
Nr.size	For Tubing	A	B	C
506102ISO63	2.5"	95.3	82.5	-
506102ISO80	3.0"	114.3	100.0	-
506102ISO100	4.0"	152.4	128.5	-
-	-	-	-	-
-	-	-	-	-